



## THE BEAST HEAVY DUTY FLAP VALVE PUMPS

---

The only AODD Flap Valve Pump designed to reliably handle packable dust, small solids, slurries, and large solids



**WARREN  
RUPP, INC.**

# THE BEAST HEAVY DUTY FLAP VALVE PUMP – FEATURES & BENEFITS

---

**Multiple Material Options** – Aluminum, Cast Iron, Stainless Steel, and Polypropylene

**Thick, Robust Wetted Chambers** for enhanced abrasion resistance

- Multiple Porting Sizes Available - 2", 3" & 4"

**Top Suction / Bottom Discharge** for easy passage of settling solids

**All Bolted Construction** for long term, leak free performance

**ESADS+ Air Distribution System** for enhanced reliability and speedy serviceability

**Best-In-Class Efficiency** – lowest air consumption in its class

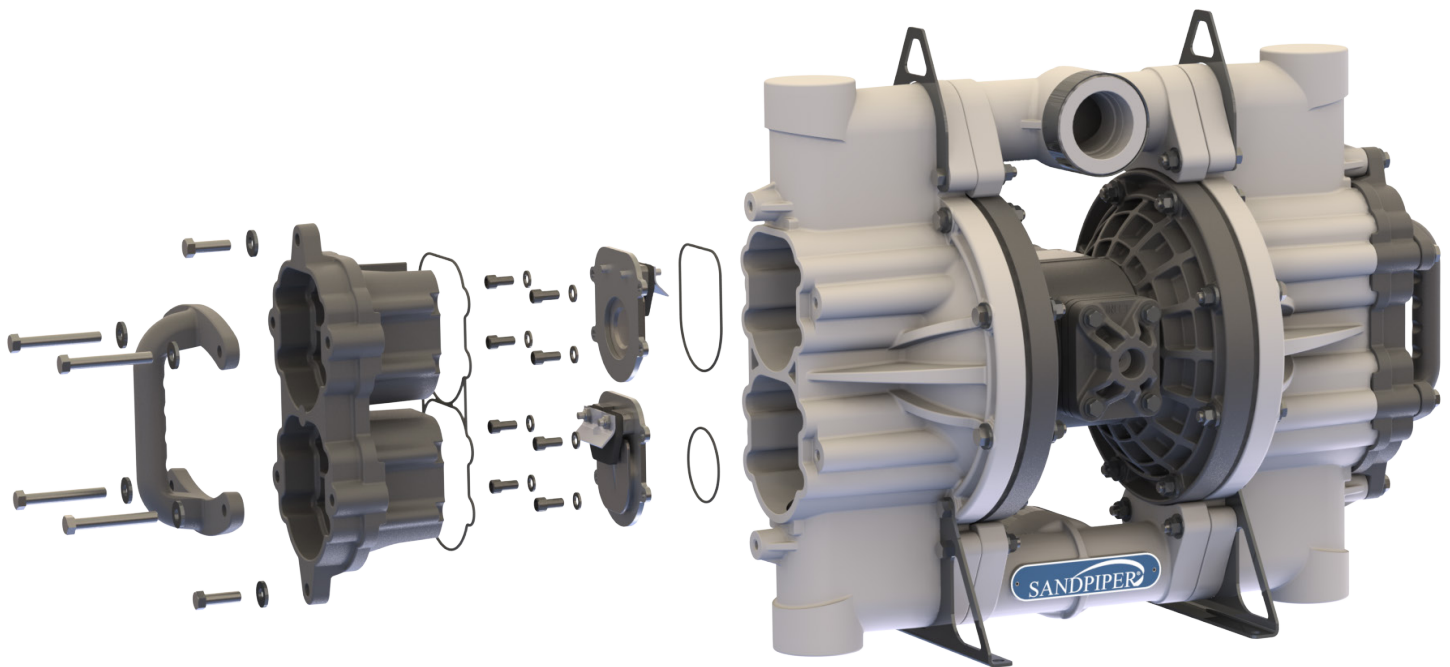

2" Non – Metallic (Polypropylene)

2", 3" & 4" Metallic

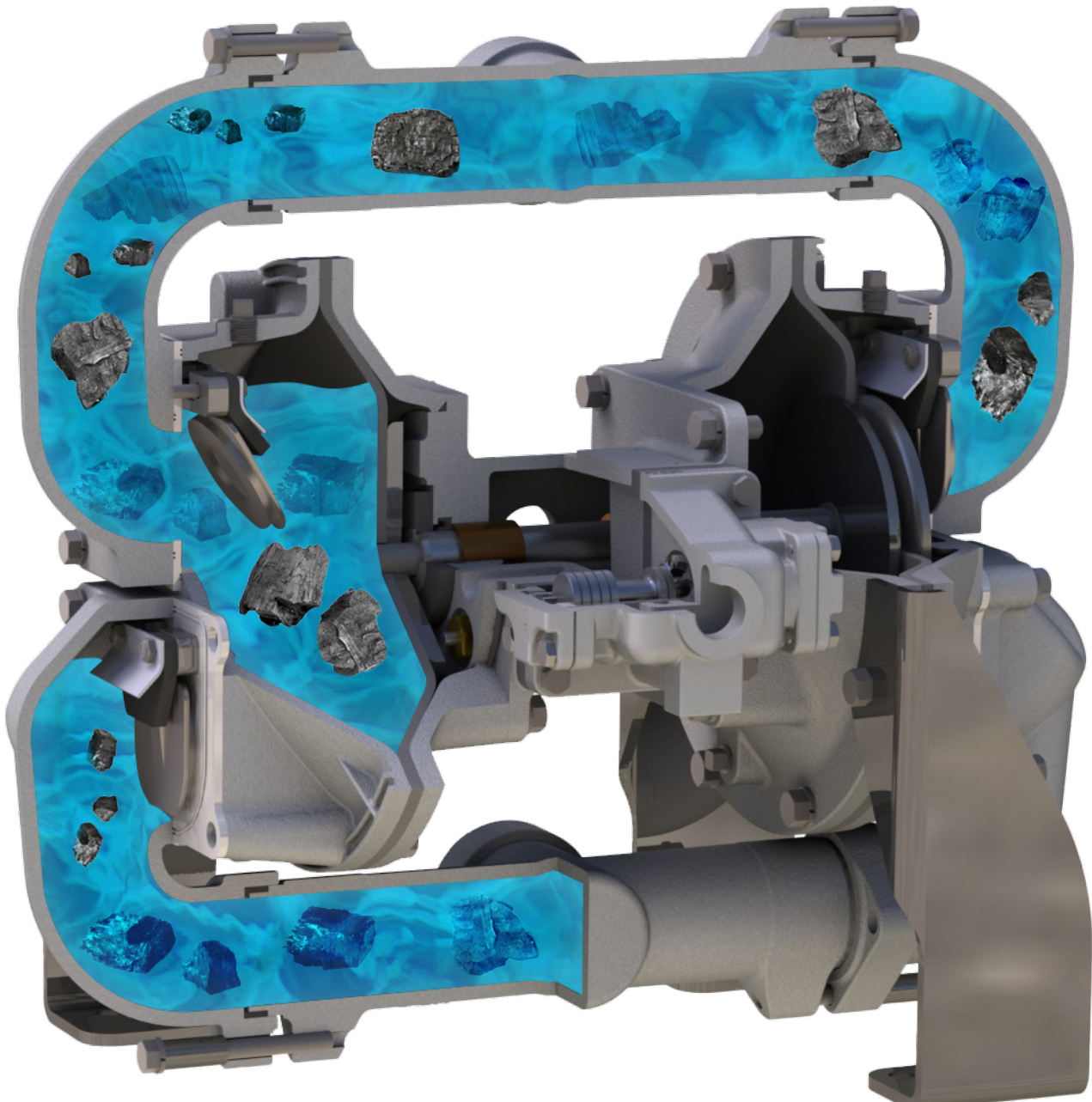

## Additional Features Non-Metallic

**Only 58 lbs (27 KG)** for easy mobility and worker safety

**Clean-Out Caps** for fast, simple maintenance or inspection without pump disassembly

**Ergonomic Handles** that can be positioned either horizontally or vertically

**Fluid Connection Options** – either FNPT, BSP or ANSI/DIN Flanged

# PATENTED FLAP DESIGN – FEATURES & BENEFITS

Patent No.: US 11,905,944 B2

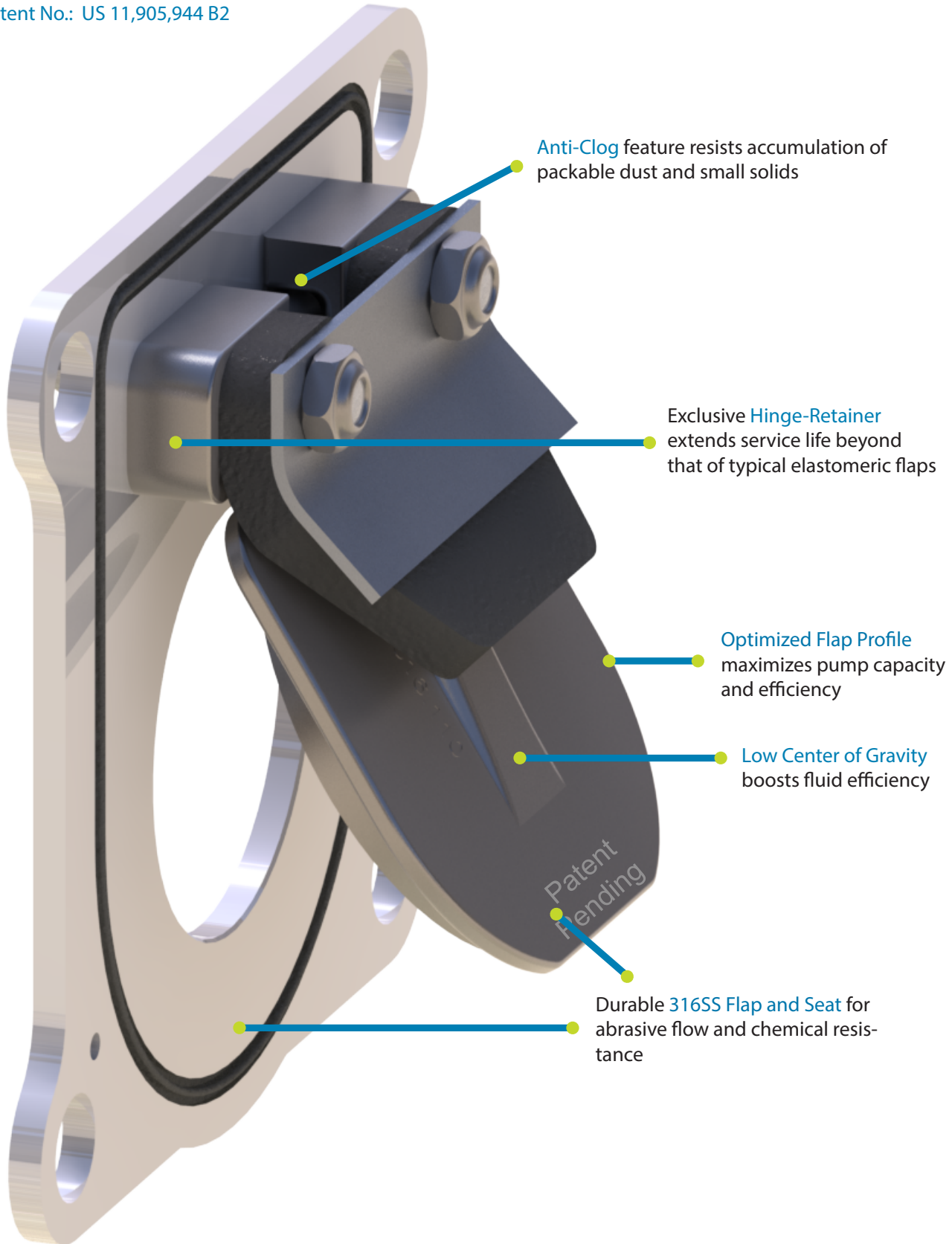

## SPECIFICATIONS NON-METALLIC

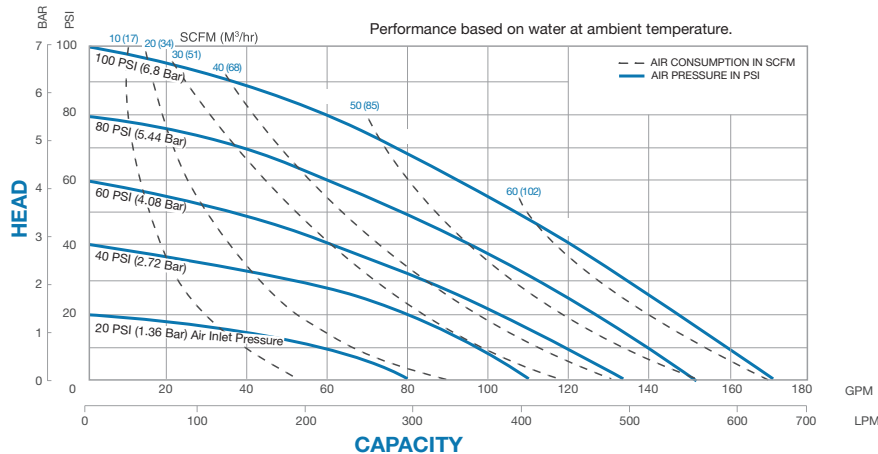

### FLOW RATE

Adjustable to 0-170 gpm (0-644 lpm)

### PORT SIZE

Inlet and Outlet 2" NPT or BSPT

### MAXIMUM OPERATING PRESSURE

100 psi (7 bar)

### DISPLACEMENT/STROKE

.50 Gallon / 1.9 liter

### MAX. PARTICLE SIZE

Diameter 1.8" (45mm)

### SHIPPING WEIGHT

Pump: 58 lbs. (27kg)

Shipping: 70 lbs. (31.7kg)

## SPECIFICATIONS 2" METALLIC

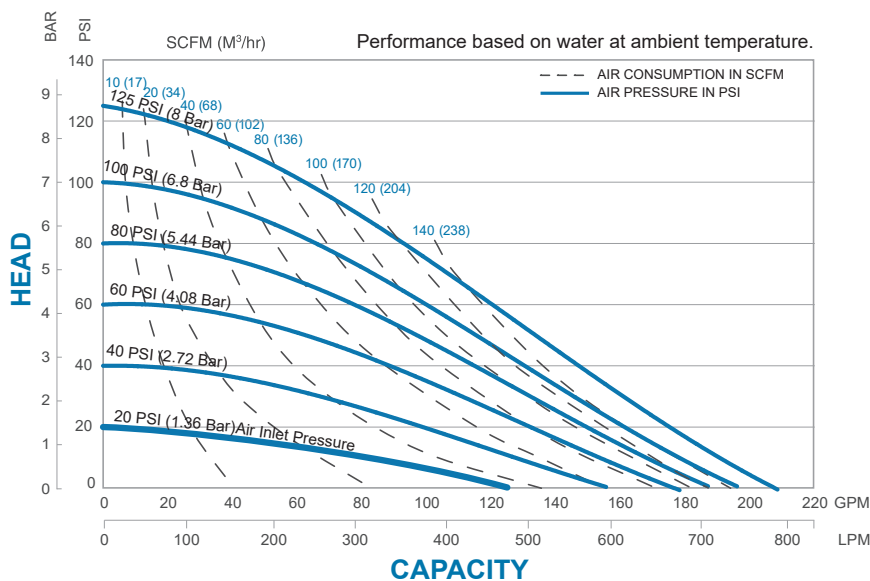

### FLOW RATE

Adjustable to 0-208 gpm (0-787 lpm)

### PORT SIZE

Inlet and Outlet 2" NPT or BSPT

### MAXIMUM OPERATING PRESSURE

125 psi (8.6 bar)

### DISPLACEMENT/STROKE

.50 Gallon / 1.9 liter

### MAX. PARTICLE SIZE

Diameter 1.8" (45mm)

### SHIPPING WEIGHT

Aluminum 88 lbs. (39.9kg)

Cast Iron 130 lbs. (59kg)

Stainless Steel 140 lbs. (63.5kg)



## SPECIFICATIONS 3"/4" ALUMINUM

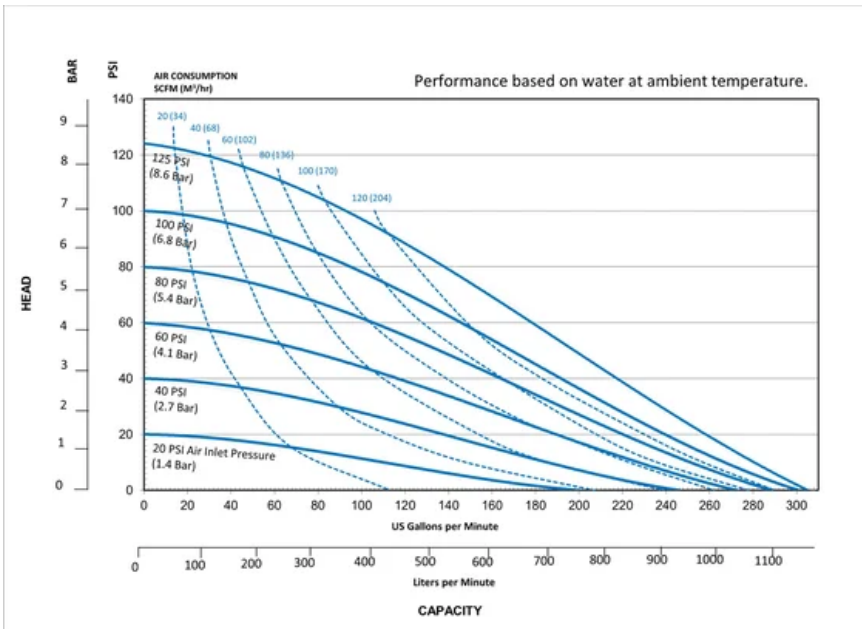

### FLOW RATE

0 to 303 gpm (1147 lpm)

### PORT SIZE

3" 150# ANSI Flange

4" 150# ANSI Flange

### MAXIMUM OPERATING PRESSURE

100 psi (7 bar)

### DISPLACEMENT/STROKE

1.15 gallons (4.37 liters)

### MAX. PARTICLE SIZE

Up to 3" (75 mm)

### SHIPPING WEIGHT

SPB30 345 lbs (151 kg)

SPB40 415 lbs (182 kg)

## SPECIFICATIONS 3"/4" CAST IRON

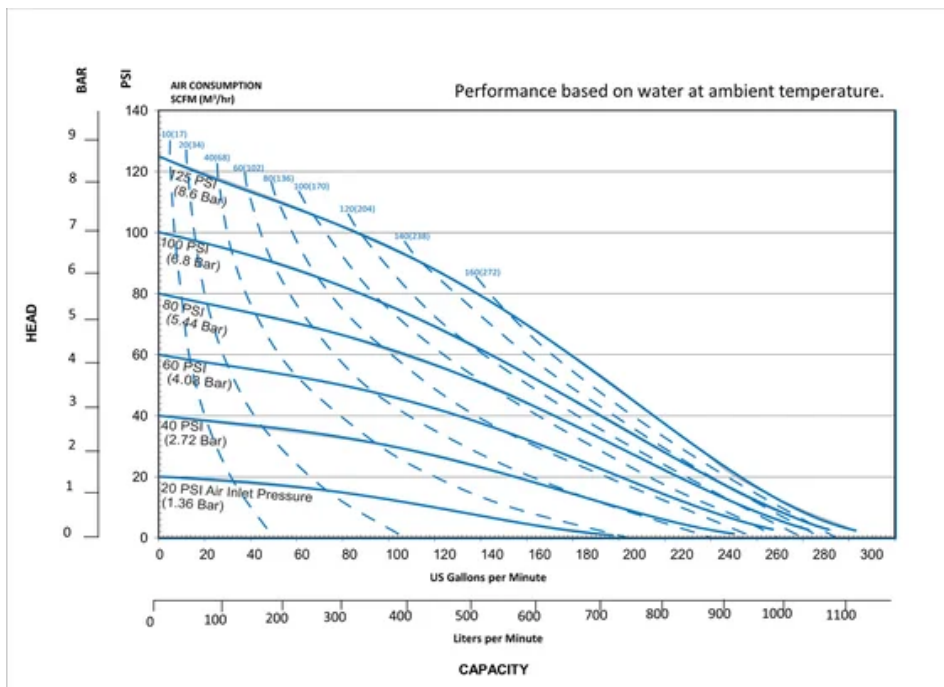

### FLOW RATE

0 to 303 gpm (1147 lpm)

### PORT SIZE

3" 150# ANSI Flange

4" 150# ANSI Flange

### MAXIMUM OPERATING PRESSURE

125 psi (8.6 bar)

### DISPLACEMENT/STROKE

1.15 gallons (4.37 liters)

### MAX. PARTICLE SIZE

Up to 3" (75 mm)

### SHIPPING WEIGHT

SPB30 400 lbs (175 kg)

SPB40 470 lbs (206 kg)

## COMMON BEAST APPLICATIONS

---



### Mine Dewatering

- Coal slurry transfer
- Mine face dewatering
- Roadway and drift water evacuation

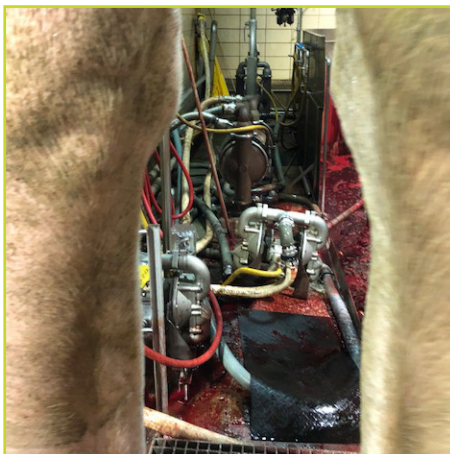

### Meat & Poultry Processing

- Animal blood transfer
- Eviscerated animal parts transfer
- Wastewater sludge



### Chemical Sumps

- Debris (leaves & needles, dirt, trash, ear plugs, etc...)
- Stray chemicals
- Variable fluid depths

**SANDPIPER®**

Warren Rupp, Inc.  
A Unit of IDEX Corporation  
800 North Main Street  
Mansfield, OH 44902 USA

Phone: 419.524.8388  
Fax: 419.522.7867  
SANDPIPERPUMP.COM



Scan to learn more



Visit [www.sandpiperpump.com](http://www.sandpiperpump.com) and click on "Find a distributor" to contact your local distributor to place your order

©Copyright 2025 Warren Rupp, Inc. All Rights Reserved.

SP\_BEASTBrochure-rev0525